

# The Twist

The design intent is to create a modern luminaire incorporating sustainable technology representing the high tech company located in the Silicon Valley. The luminaire acts as a sculpture as well, interacting with the visitors and the architecture. The vortex-like feature light fixture in the center of the lobby creates a centralized space that seating and display counters wrap around the fixture, allowing visitors to view the fixture at all angles.

Shifted and stacked layers enhance the dynamic geometric shape that provide a theatrical effect in the space. The form of the luminaire reflects the shape of floor plan and skylight, allowing complete spatial experience. The luminaire hangs below the skylight that during the day the natural light becomes an accent light highlighting the featured fixture, and at the same time the natural light coming from the skylight brings illumination that potentially reduce the use of artificial lighting.

The luminaire uses LED strips as artificial light source. The reflector directs and shapes LED light, reflecting it off their concave inner surfaces and directing it towards diffuser. The frosted acrylic acts as diffuser that produces even distribution of glow in each layer. The LED illumination produces the color temperature of 6500K that blends in with natural light. The use of green materials like LEDs and solid surfacing fulfills the concept of sleek design, and provides high efficacy to the fixture as well.



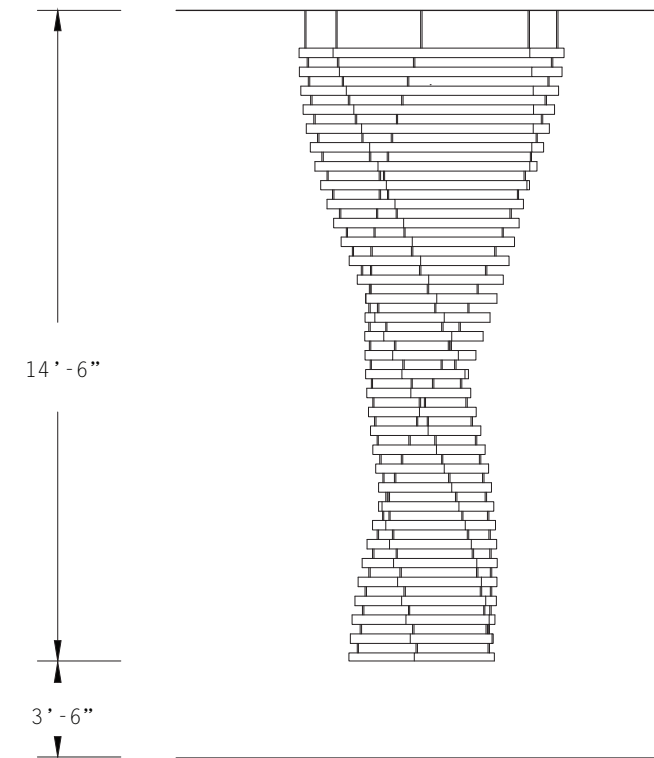
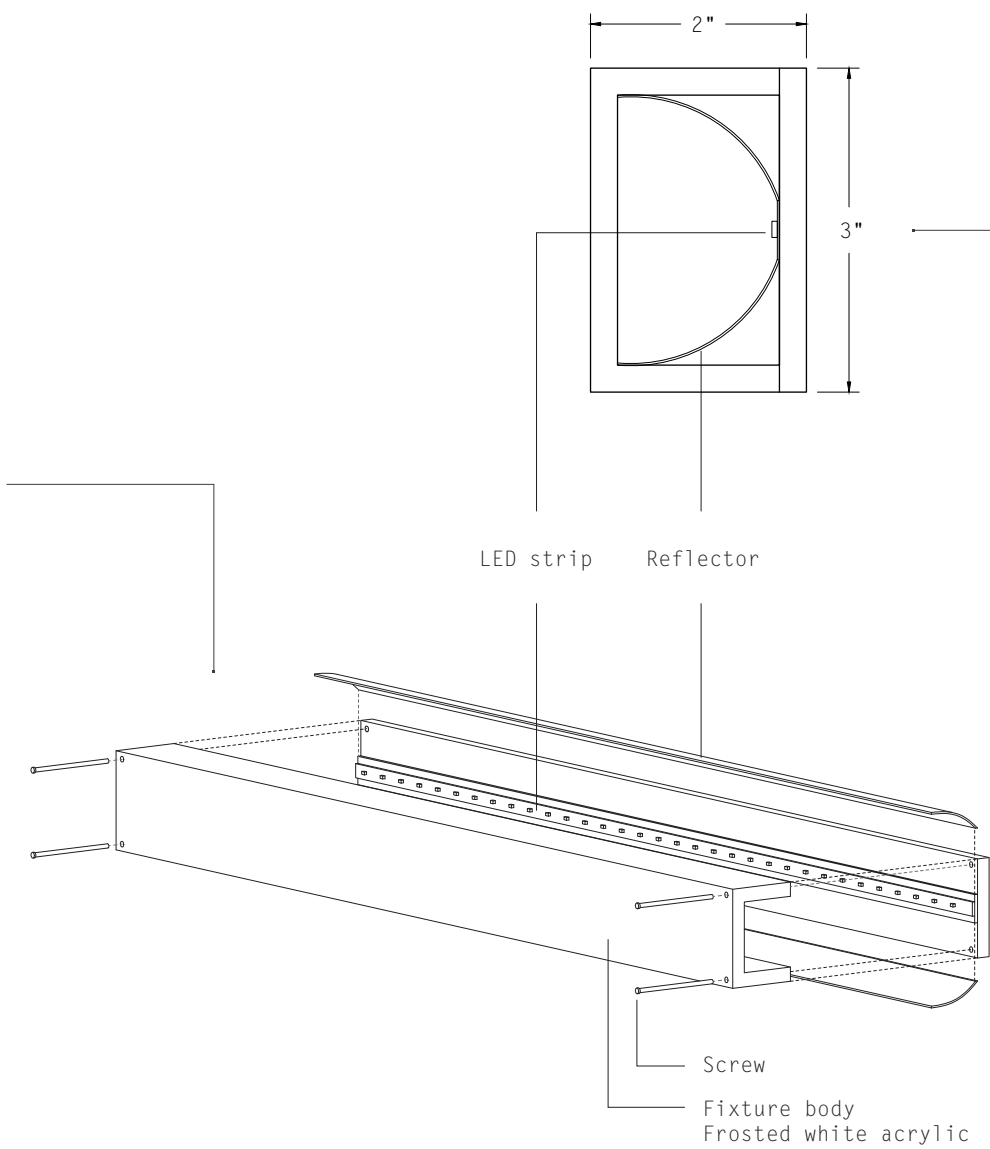
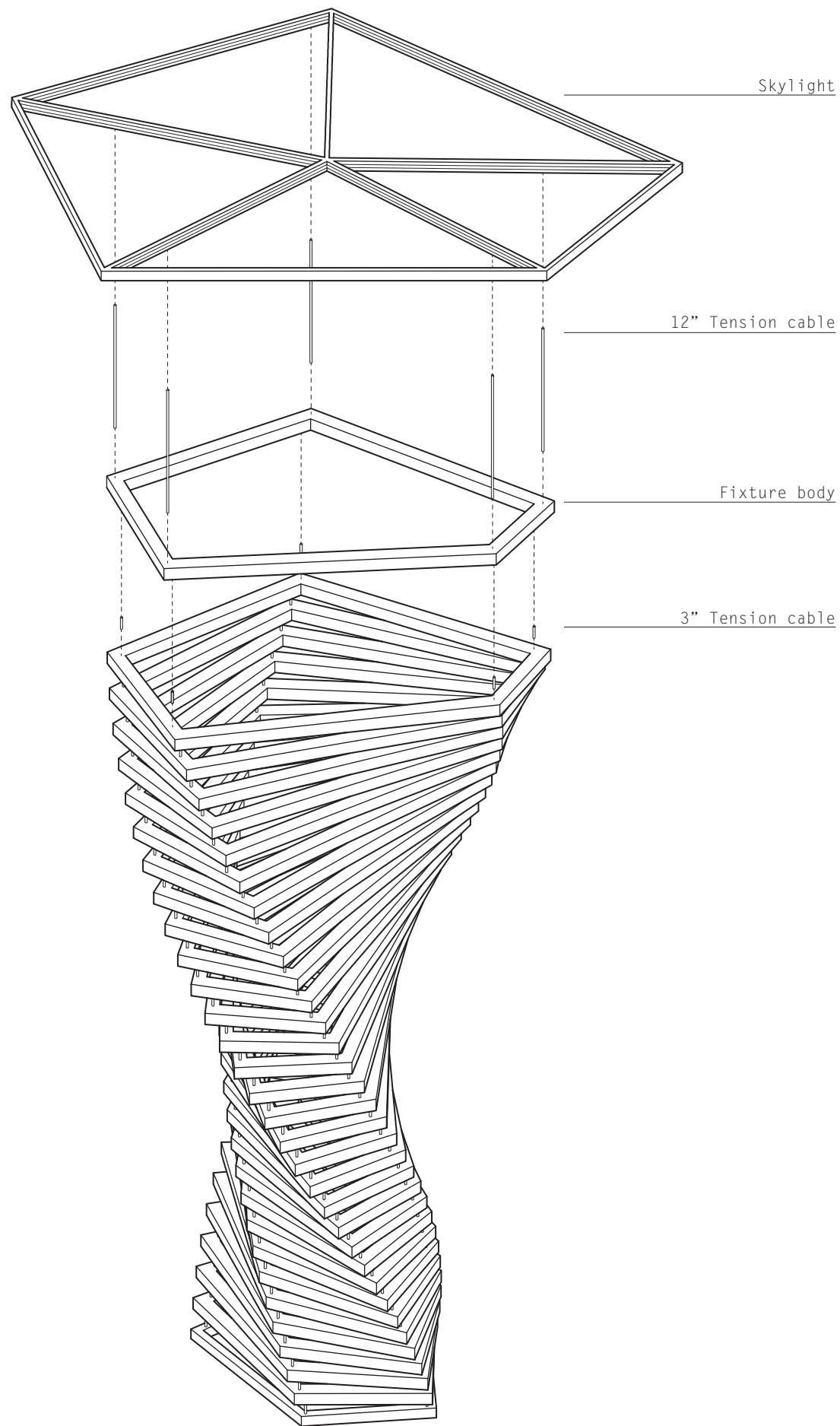

Fixture elevation

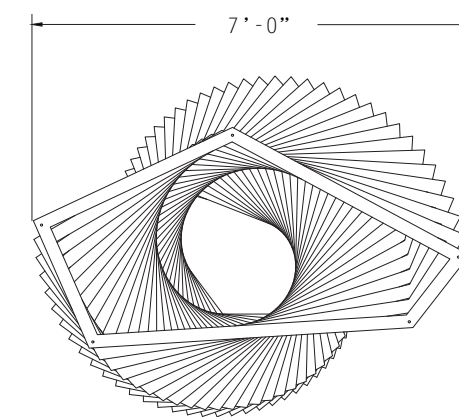

Fixture plan view

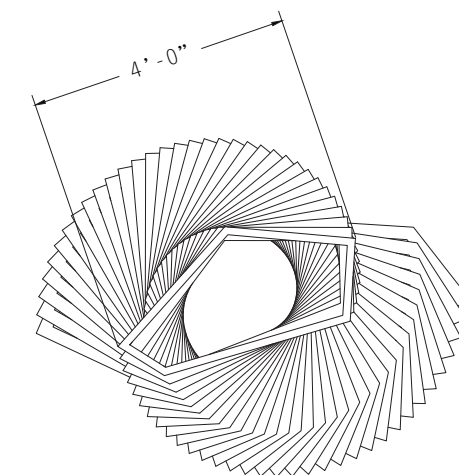

Fixture bottom view

SPECIFICATION

- Material/ 1/4" solid surfacing
- Color/ Matte white
- Dimensions/ 4'-7' W x 14'-6" H; each layer is 3" high
- Typology/ LED strip
- Chips per ft./ 18
- Beam angle/ 120 degrees
- Lumen/ 80 lm per ft.
- Color temperature/ 6500K cool white
- CRI/ 80

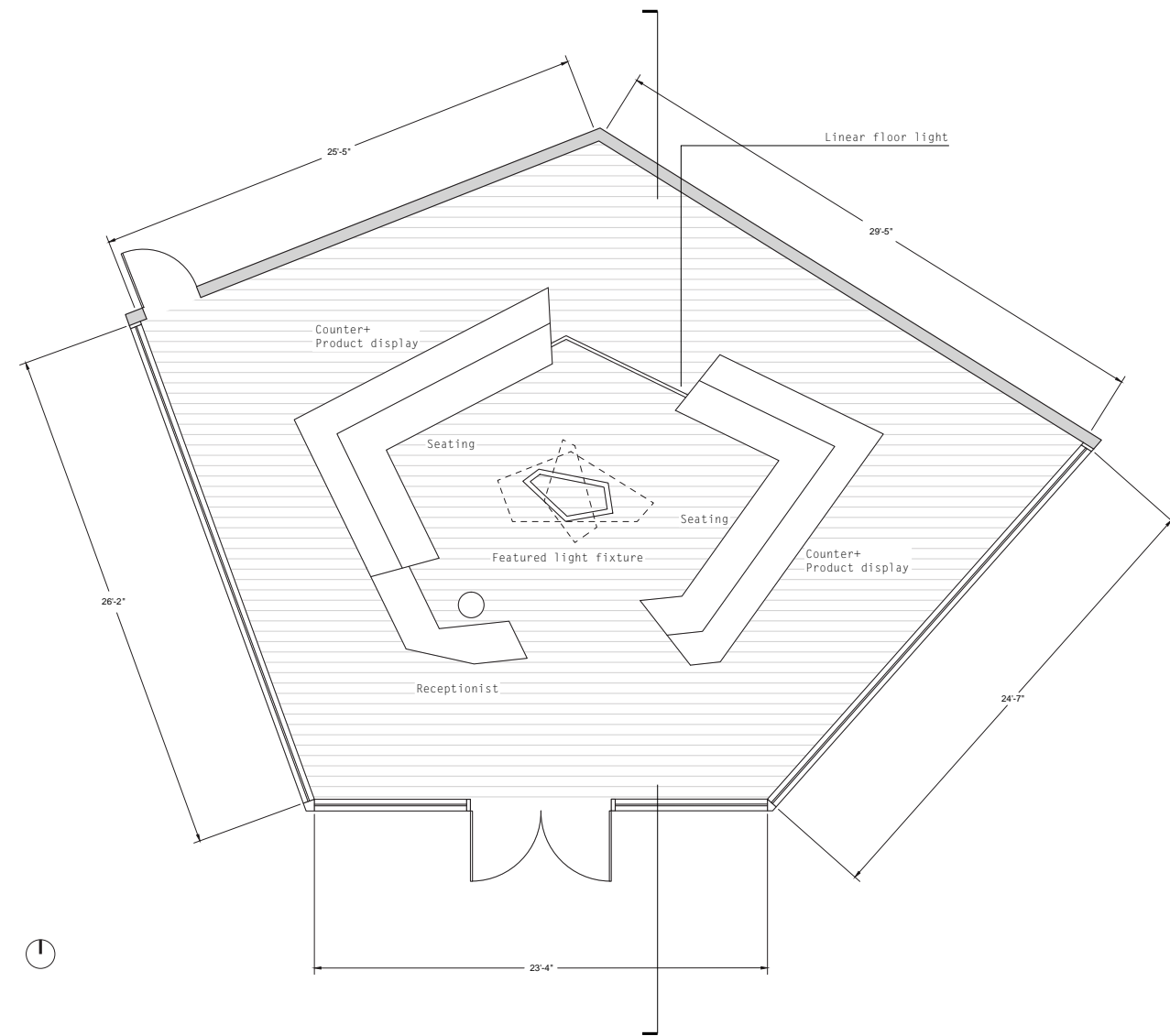

Lobby floor plan | not to scale

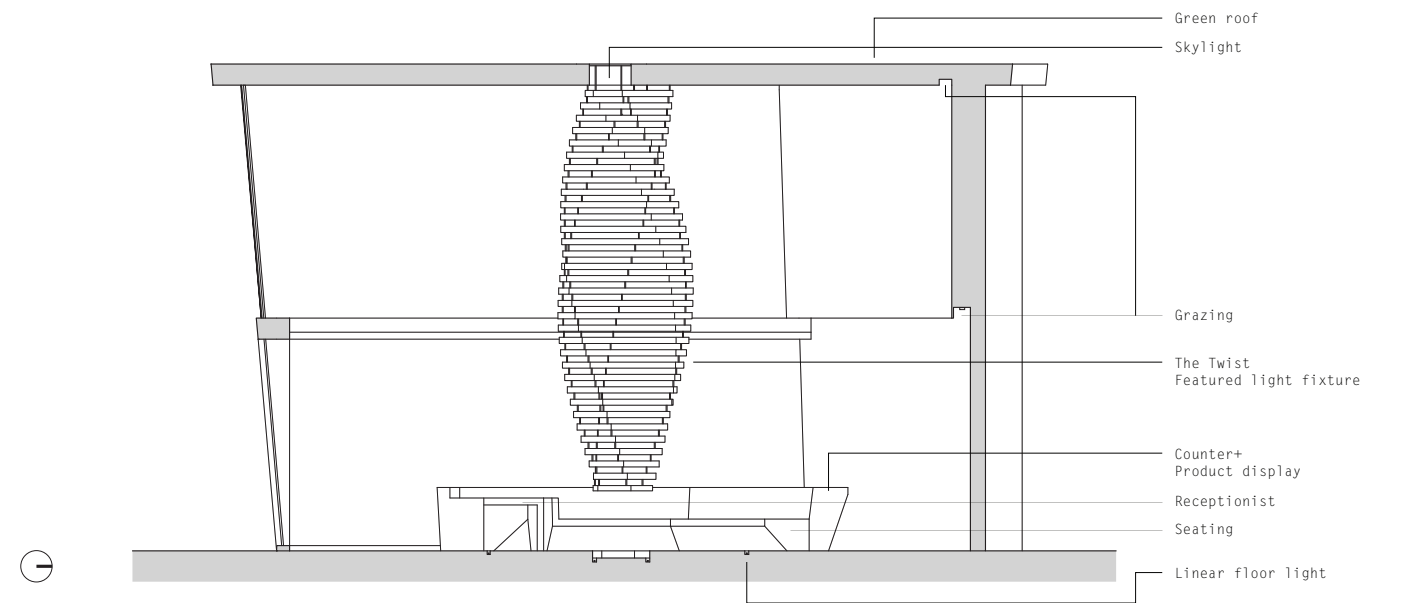

Transverse section | not to scale



Daylight diagram



Layered lighting diagram



Artificial lighting diagram (night)

